

EXPlora

Zone 2 Hazardous Area Connector

Information and Specification

GB

IMPORTANT - PLEASE READ

Before using the connector, it is important that these instructions are carefully read and understood to ensure the connector system is completely water tight and electrically safe. IF IN DOUBT CONSULT A QUALIFIED ELECTRICIAN.

The EXPlora is available in 2, 3, 4, 5, 7 and 10 pole versions. The 3, 4, 5 and 7 pole versions have a 'Leading Earth' pin arrangement for added protection.

The socket insert of the connector should always be connected to the supply. The pin insert of the connector should always be connected to the load or electrical device. The pin or socket inserts can be fitted to any body style to provide the correct arrangement for the application.

The connectors must de-energised before separation. The screw-on sealing caps must be fitted to both connectors immediately after separation to maintain the IP rating.

To ensure efficient sealing use only smooth, circular cable with appropriate gland for the cable diameter. The sealing glands supplied with the Flex and Flex In-line connectors accommodate cable sizes as follows:

Cable acceptance: 2.5mm² - 4mm² (13-10AWG) conductor, single or multi-stranded

Version	Cable Dia. Cable	Cable Gland Colour
EXP-0	13-15mm	Yellow (standard)
EXP-0	11-13mm	Black
EXP-0	9-11mm	White
EXP-0	7-9mm	Dark Grey
EXP-A	20-22mm	Yellow (standard)
EXP-A	18-20mm	Black
EXP-A	16-18mm	White
EXP-A	14-16mm	Dark Grey

NOTE: To ensure that the correct sealing properties of the connector are achieved it is imperative that all 'O' rings and seals are correctly located and seated before assembly.

Ratings and Approvals

Electrical	2, 3, 4 and 5 Pole	7 Pole	10 Pole
Current Rating:	18A, per contact	16A, per contact	10A, per contact
Voltage Rating:	600Vac/dc (50/60Hz)	415Vac/dc	250Vac/dc
Environmental			
Sealing:	IP68, EN60529:2001 tested at 10m depth for 14 days		
Approvals:	ATEX Zone 2 and Zone 22 IEC60079-0:2007 IEC60079-15:2005		
	Certificate No. - Baseefa09ATEX0232X		
	Classification - Ex nA IIC T6 Gc EX tc IIIC T85°C Dc		

Details of approval marking on each of the connector bodies.

Note: Baseefa09 denotes the year of certification. (09=2009).

EXPlora IP68
II 3 GD Baseefa09ATEX0232X
Ex nA IIC T6 Gc
Ex tc IIIC T85°C Dc
Tamb -20°C to +55°C

BULGIN

Elektron Components Ltd

Melville Court, Spilsby Road, Romford, Essex, UK, RM3 8SB
www.bulgin.co.uk

1

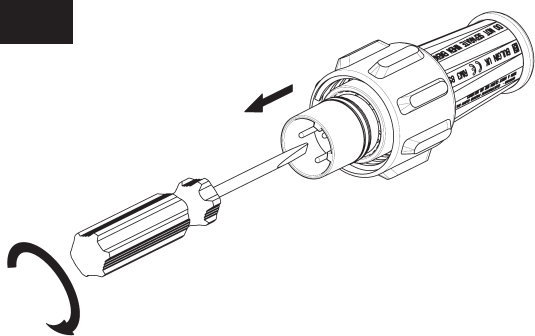

2 - EXP-0

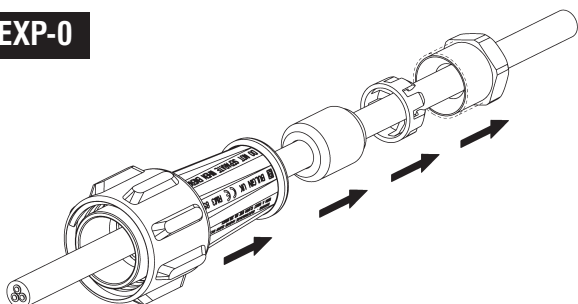

2 - EXP-A

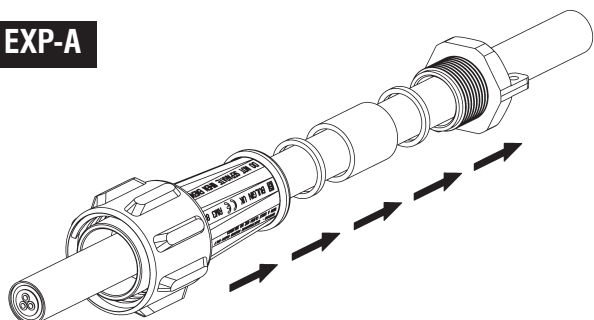

3

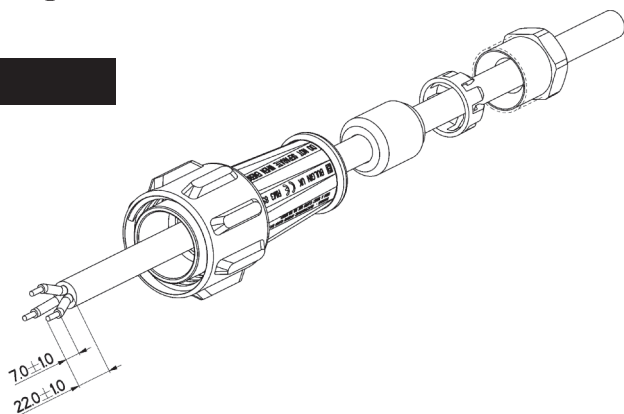

4

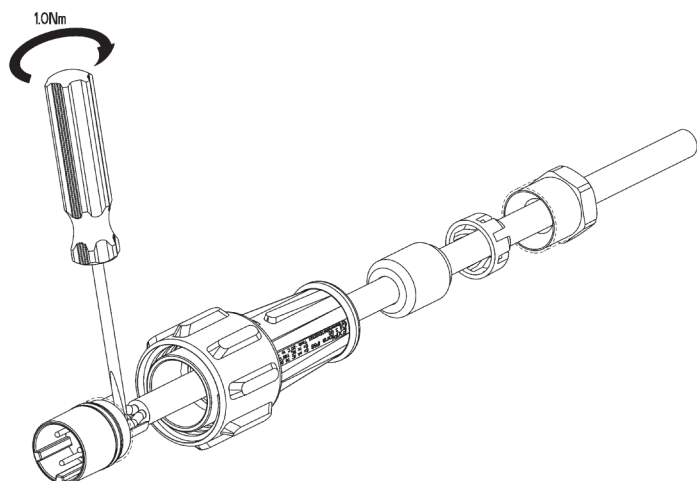

5

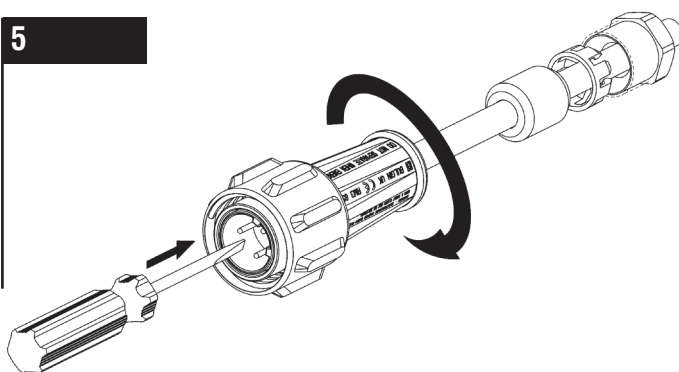

6

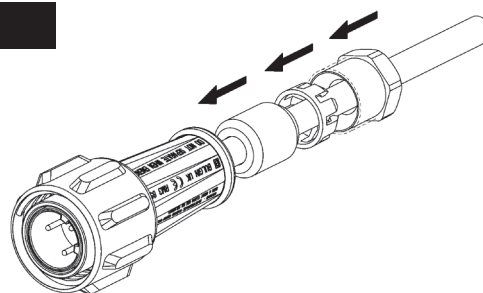

7 - EXP-0

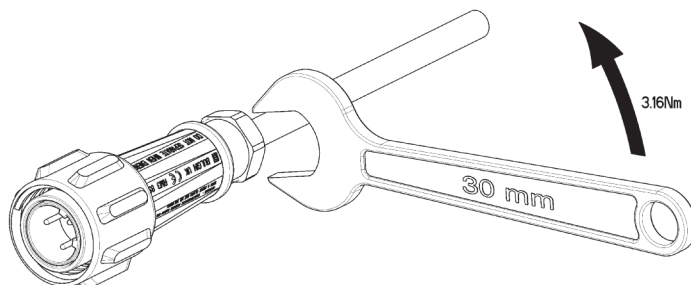

7 - EXP-A

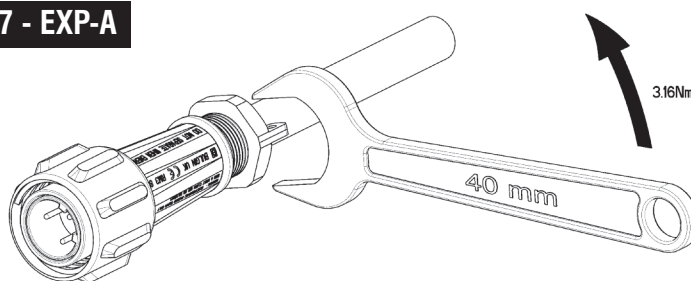

8 - EXP-A

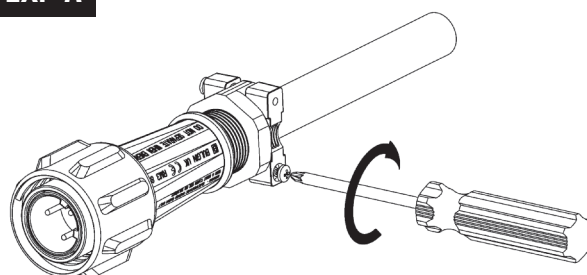

1

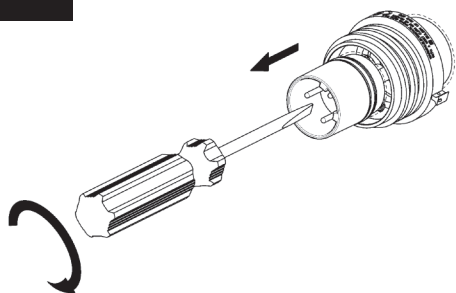

5

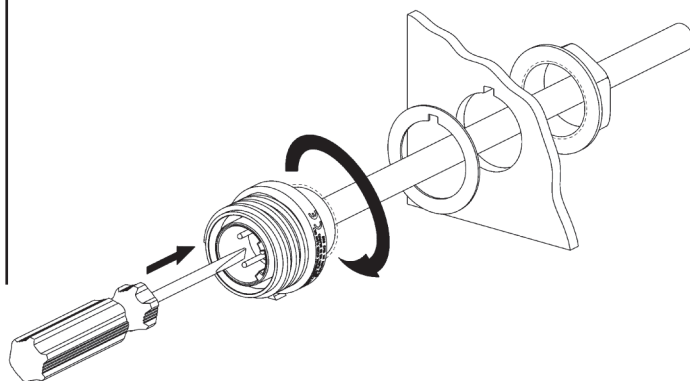

2

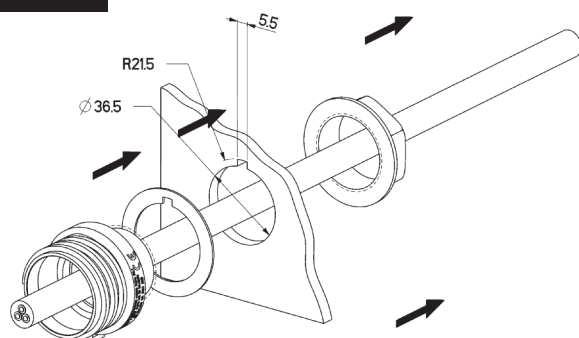

6

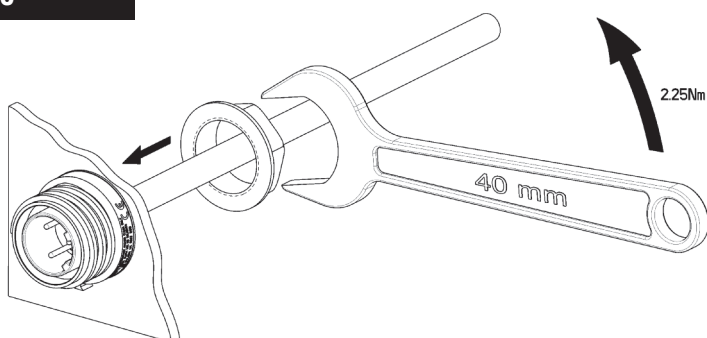

3

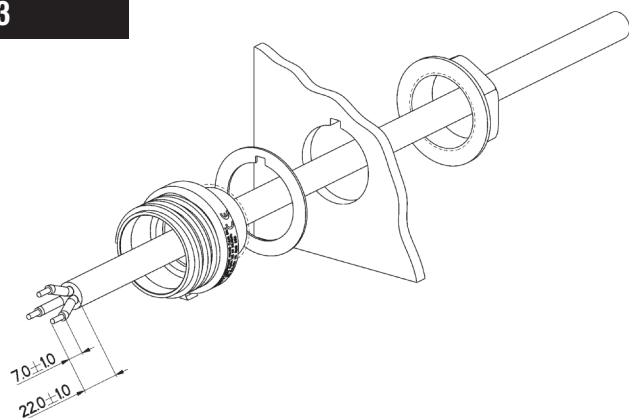

4

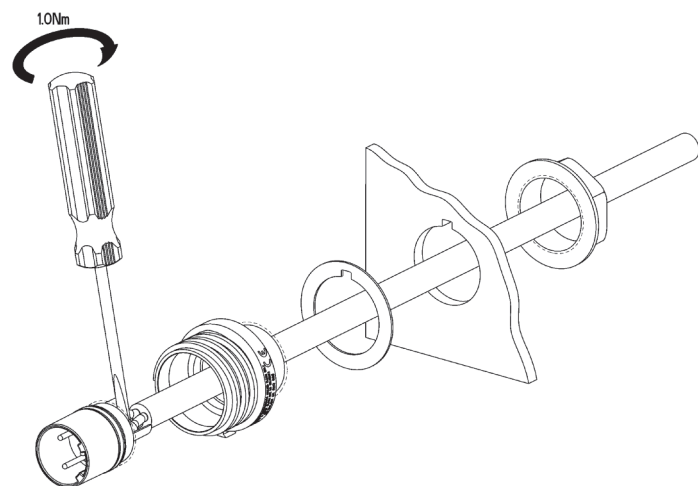

1

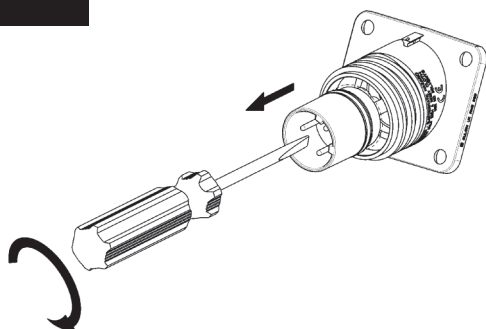

2

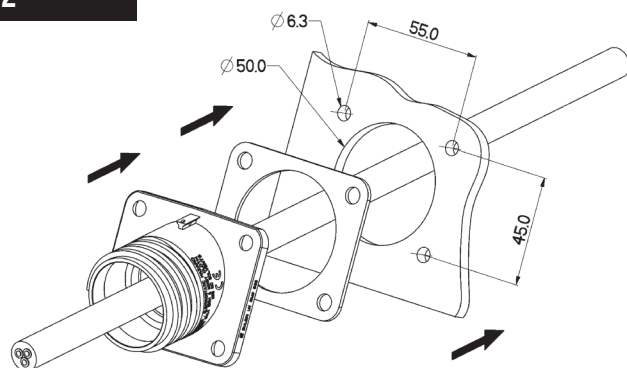

3

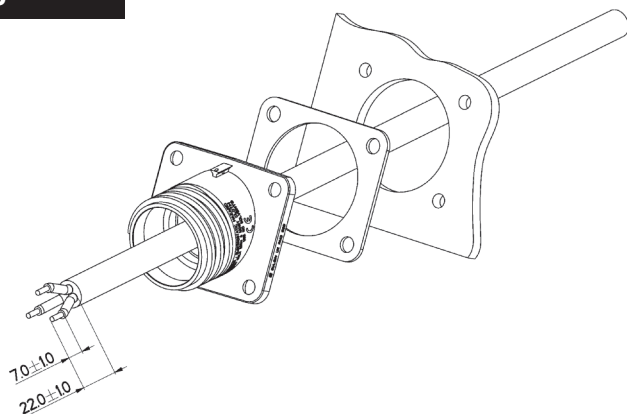

4

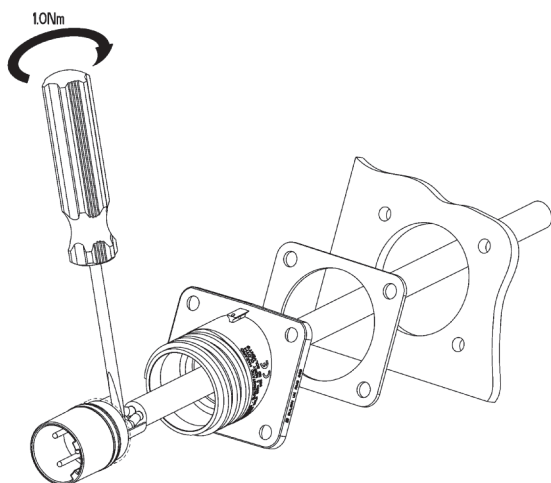

5

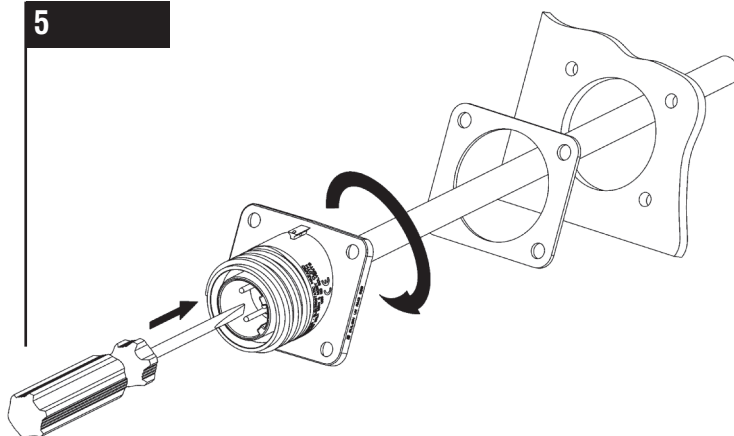

6

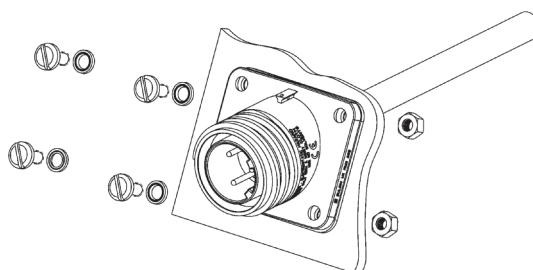

7

