

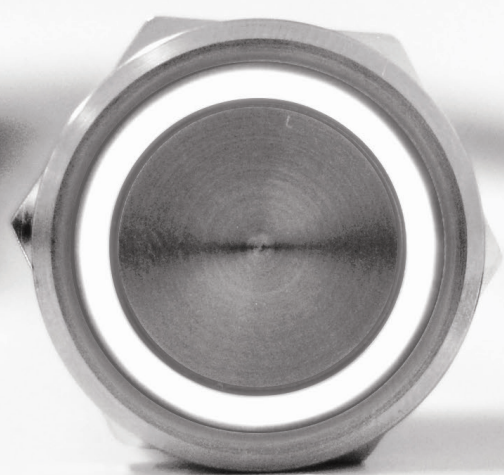

Piezo Switch Series Datasheets



“

Piezo switches from Bulgin, designed to withstand the harshest of environments.

Unlike traditional switches, Piezo switches have no moving mechanical parts making them extremely durable, withstanding millions of actuations and requiring little to no maintenance.

”

Part No System

MPZ

016

X

XX

X

X

Series
MPZ - Non Illuminated
MPZI- Illuminated

Body Diameter
016 = 16mm
019 = 19mm
022 = 22mm

Profile
F = Flat Head
G = Guided Profile

Colour
BL = Blue
RD = Red
GN = Green
DI = Red and green

Led Voltage
24v

Type
L = Latching Toggle
(No Suffix= Momentary)

Examples:

MPZ022/F = Non Illuminated Piezo, 22mm, Flathead

MPZI022/F/RD/24 = Illuminated Piezo, 22mm, Flathead, Red Illumination, 24 volt

MPZI022/G/BL/24/L = Illuminated Piezo, 22mm, Guided Profile, Blue Illumination, 24 volt, Latching Toggle

Circuit Specifications

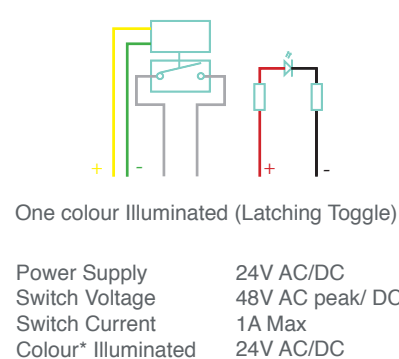
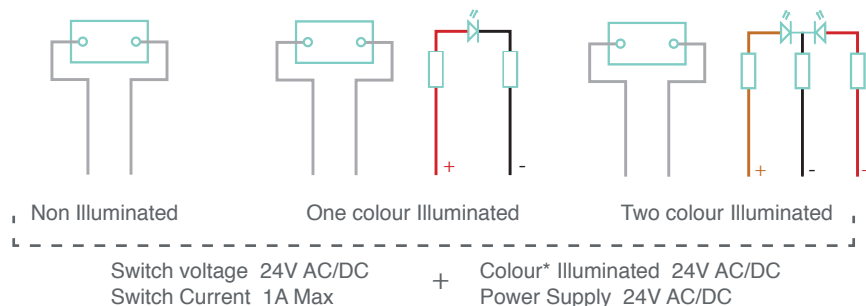

Other switches are available upon request*

Piezo Switches
16mm Stainless Steel
Non Illuminated



16MM Stainless Steel Non Illuminated



MPZ016

Non Illuminated
20 cm lead
Flathead or Guided profile

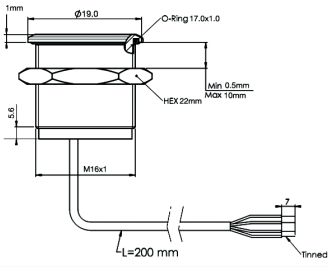

Specification

MPZ016

Type	Momentary
Material	Stainless Steel (Aluminium upon request)
Maximum Voltage	24V AC/DC
Switch Resistance "ON"	<1Ω
Switch Resistance "OFF"	5MΩ
Capacitance	100pF
Switching current (momentary)	1A Max
Switching current (prolonged)	300 mA
Switching pulse time (momentary)	up to 0.3 sec
Switching pulse time (prolonged)	up to 6 sec
Actuating force, typically	3-5 N
Life cycle	10 Million

Environmental specs

Sealing	IP68; IP69K
Operating temperature	-40°C to +85C°
Vibration resistance	5-500Hz/9.4m
Shock resistance	75g (g-force)
RoHS compliance	Compliant

Circuit Specification

16MM Stainless Steel Non Illuminated

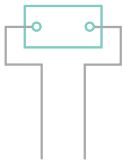

Switch voltage	24V AC/DC
Switch Current	1A Max
Power Supply	24V AC/DC

Piezo Switches
19mm Stainless Steel
 Illuminated and Non Illuminated



19MM Stainless Steel Illuminated



MPZI019

Blue Illumination
 20 cm lead
 Flathead

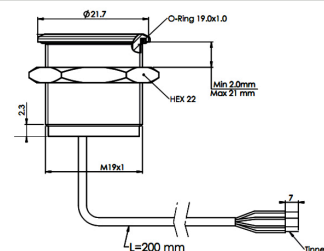

19MM Stainless Steel Non Illuminated

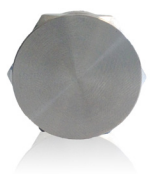

MPZ019

Non Illumination
 20 cm lead
 Flathead

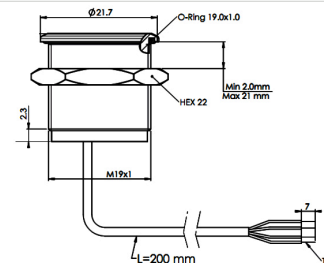

Specification

MPZ019, MPZI019

Type	Momentary
Material	Stainless Steel (Aluminium upon request)
Maximum Voltage	24V AC/DC
Switch Resistance "ON"	<1Ω
Switch Resistance "OFF"	5MΩ
Capacitance	100pF
Switching current (momentary)	1A Max
Switching current (prolonged)	300 mA
Switching pulse time (momentary)	up to 0.3 sec
Switching pulse time (prolonged)	up to 6 sec
LED Illumination	24V AC/DC
Actuating force, typically	3-5 N
Life cycle	10 Million

Environmental specs

Sealing	IP68; IP69K
Operating temperature	-40°C to +85°C°
Vibration Resistances	5-500Hz/9.4m
Shock resistance	75g (g-force)
RoHS compliance	Compliant

Circuit Specification

19MM Stainless Steel Non Illuminated

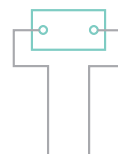

Switch voltage 24V AC/DC
 Switch Current 1A Max
 Power Supply 24V AC/DC

19MM Stainless Steel Illuminated

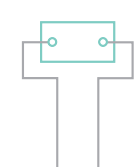

Switch voltage 24 V AC/DC
 Switch Current 1A Max
 Colour* Illuminated 24V AC/DC
 Power Supply 24V AC/DC

Piezo Switches
22mm Stainless Steel
 Illuminated and Non Illuminated



22MM Stainless Steel Non Illuminated

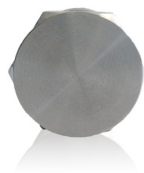

MPZ022

Non Illumination
 20 cm lead
 Flathead

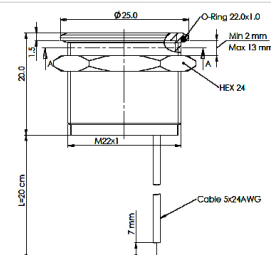

22MM Stainless Steel Illuminated



MPZI022

Red or Green Illumination
 1 colour
 20 cm lead
 Flathead

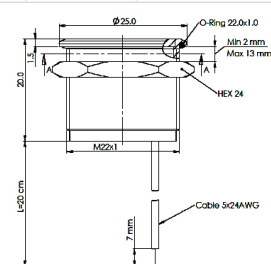

22MM Stainless Steel Illuminated



MPZI022

Red and Green Illumination
 (2 colour)
 20 cm lead
 Flathead

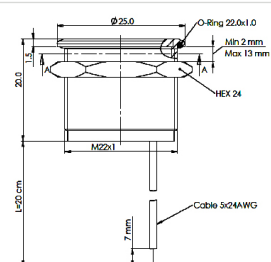

Specification

MPZ022, MPZI022

Type	Momentary
Material	Stainless Steel (Aluminium upon request)
Maximum Voltage	24V AC/DC
Switch Resistance "ON"	<1Ω
Switch Resistance "OFF"	5MΩ
Capacitance	100pF
Switching current (momentary)	1A Max
Switching current (prolonged)	300 mA
Switching pulse time (momentary)	up to 0.3 sec
Switching pulse time (prolonged)	up to 6 sec
LED Illumination	24V AC/DC
Actuating force, typically	3-5 N
Life cycle	10 Million

Environmental specs

Sealing	IP68; IP69K
Operating temperature	-40°C to +85°C°
Vibration Resistances	5-500Hz/9.4m
Shock resistance	75g (g-force)
RoHS compliance	Compliant

Circuit Specification

22MM Stainless Steel Non Illuminated

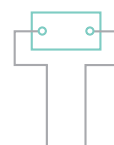

Switch voltage 24V AC/DC
 Switch Current 1A Max
 Power Supply 24V AC/DC

22MM Stainless Steel Illuminated

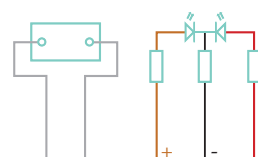

Switch voltage 24V AC/DC
 Switch Current 1A Max
 Colour* Illuminated 24V AC/DC
 Power Supply 24V AC/DC

22MM Stainless Steel Illuminated



MPZI022/L

Blue Illumination

1 colour

20 cm lead

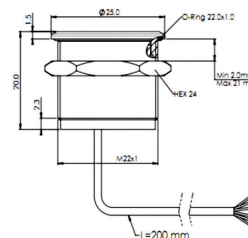

Specification

MPZI022/L

Type	Latching Toggle
Material	Stainless Steel (Aluminium upon request)
Power Supply	24V AC/DC
Switching voltage	48V AC peak/DC
Switch Resistance “ON“	<0.7Ω
Switch Resistance “OFF“	>1000MΩ
Capacitance	<90pF
Switching current	1A Max
LED Illumination	24V AC/DC
Actuating force, typically	3-5 N
Life cycle	10 Million

Environmental specs

Sealing	IP68; IP69K
Operating temperature	-40°C to +85°C°
Vibration Resistances	5-500Hz/9.4m
Shock resistance	75g (g-force)
RoHS compliance	Compliant

Circuit Specification

22MM Stainless Steel Latching Toggle Illuminated

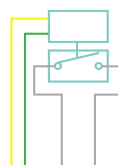

Power Supply	24V AC/DC
Switch Voltage	48V AC peak/ DC
Switch Current Max	1A Max
Colour* Illuminated	24V AC/DC



Europe

Elektron Technology,
Broers Building,
JJ Thomson Avenue, Cambridge,
CB3 0FA,

Tel: +44 (0)1223 371 000
Email: europe@elektron-technology.com

The Americas

Elektron Technology
5856 Corporate Suite 220
Cypress
CA 906030

Tel: +1 760 343 3650
Email: americas@elektron-technology.com

China and Asia

Elektron Technology,
Room 902, 568 Hengfeng,
Henhui Int Building,
Shanghai 200070,

Tel: +86 (21)604 00060
Email: asia@elektron-technology.com