

High Efficiency Eighth Brick DC-DC Converters

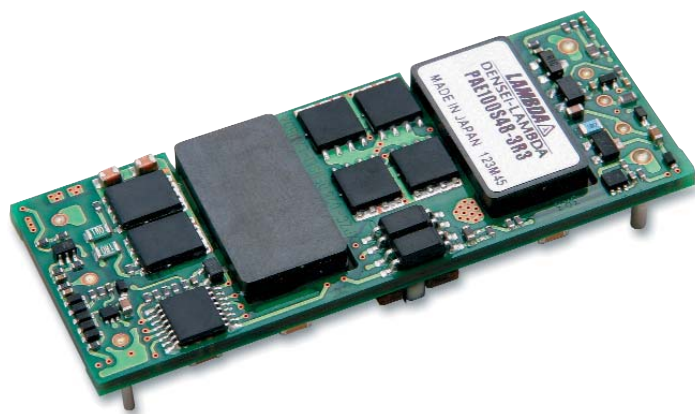

- ◆ Industry Standard Package and Pin Out
- ◆ RoHS Compliant
- ◆ Output Currents up to 30 Amps
- ◆ Designed for Telecom Standards
- ◆ Output Voltage Adjustment
- ◆ Remote On / Off

Key Market Segments & Applications

Telecommunications
Data Communications
Networking Equipment
Test Equipment
Industrial Electronics
Distributed Power Architecture

PAE Features and Benefits

Feature

- ◆ High Efficiency
- ◆ Same Pinout as Quarter Bricks
- ◆ Meets Basic Isolation

Benefit

- ◆ Reduces System Heating
- ◆ Reduces PCB Area
- ◆ Assists Safety Approvals

Specifications

ITEMS		MODELS	PAE50S48-1R8 PAE100S48-1R8	PAE50S48-2R5 PAE100S48-2R5	PAE50S48-3R3 PAE100S48-3R3	PAE50S48-5 PAE100S48-5
Nominal Output Voltage			1.8	2.5	3.3	5
Input Voltage Range	VDC		36-76			
Output Voltage Accuracy	%		±1			
Max Ripple & Noise	mV		100			
Max Line Regulation	mV		10			
Max Load Regulation	mV		10			
Overcurrent Protection (1)	-		PAE50 models 105% - 150%, PAE100 models 105% - 140%			
Overvoltage Protection (max) (2)	-		115% - 135%			120%-140%
Remote Sense	-		Yes			
Remote On / Off	-		Yes (open = off; short to 0V = on)			
Operating Temperature	-		-40°C to +85°C (See website for derating)			
Operating Humidity	-		5 - 95% RH (non-condensing)			
Storage Temperature	-		-40°C to +100°C			
Storage Humidity	-		5 - 95% RH (non-condensing)			
Cooling	-		Convection or Forced Air			
I/O Isolation Voltage	-		Input to Output 1500VDC			
Vibration (non operating)	-		10 - 55Hz (1 minute), Amplitude 0.825mm (49m/s ² max) X, Y, Z 1 hour			
Shock	-		< 196.1 m/s ²			
Safety Agency Approvals	-		UL60950-1, CSA60950-1, EN60950-1, CE Mark			
Weight (Typ)	g		25			
Size (WxHxD)	mm		22.76 X 8.5 X 57.9 (See Outline Drawing)			
Warranty	-		Two Years			

Notes:

- (1) Converter shut down, auto restart
(2) Auto restart on /V models

PAE Models

Models	Voltage (V)	Adjust Range	Max. Curr. (A)	Max. Output Power (W)	Efficiency at Full Load (%)	Input Curr. (A)
PAE50S48-1R8/V	1.8	1.44 - 1.98	20	36.0	87	0.87
PAE100S48-1R8/V	1.8	1.44 - 1.98	30	54.0	87	1.30
PAE50S48-2R5/V	2.5	2.00 - 2.75	18	45.0	89	1.06
PAE100S48-2R5/V	2.5	2.00 - 2.75	25	62.5	89	1.47
PAE50S48-3R3/V	3.3	2.64 - 3.63	16	52.8	90	1.23
PAE100S48-3R3/V	3.3	2.64 - 3.63	25	82.5	90	1.91
PAE50S48-5/V	5.0	4.25 - 5.75	10	50.0	90	1.16
PAE100S48-5/V	5.0	4.25 - 5.75	20	100.0	90	2.32

Outline Drawing

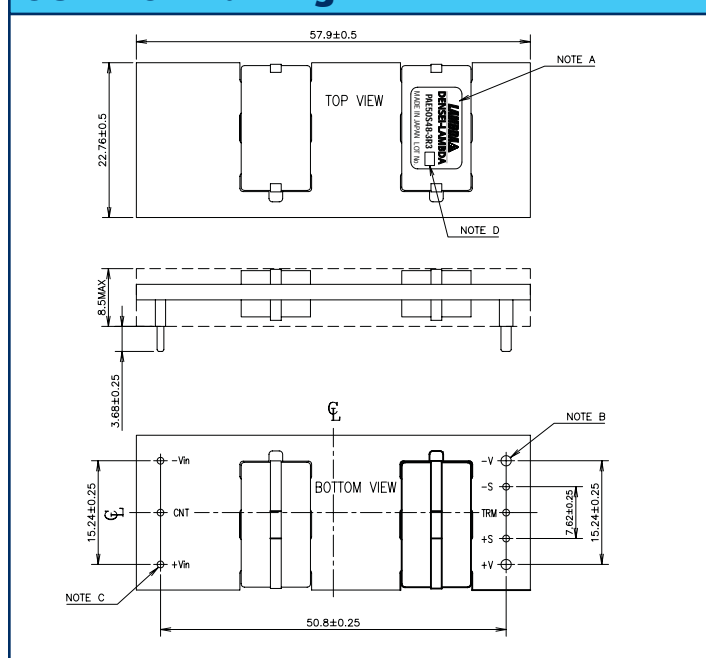

Options

Suffix	Description
Blank	Manual Reset
/V	Auto Reset (Preferred)

Derating Curve

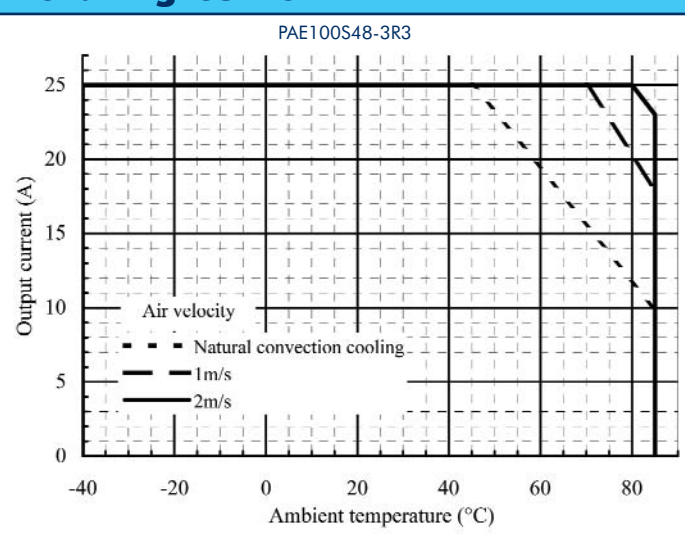

Other Lambda DC-DC Products

SX	Surface Mount 20W, 24 & 48 I/P DC-DC converters
PS	1.5-10W, 5V, 12V, 24V & 48V I/P DC-DC converters
PAQ, PAH, PAF	50-700W quarter, half & full bricks

For Additional Information, please visit
www.lambdapower.com/products/pae-series.htm